

INSTRUCTIONS:

1. Position the box between the seats and ensure the armrests do not interfere with the lid
2. Fasten the box to the cab floor using the provided #10 self-drilling screws
3. If the cab's floor slopes down to the front, also install the front mounting bracket
4. (Optional) Bolt the box to the headboard using the provided 1/4-20 screws and nuts

NOTE: The Front Mounting Bracket is not required for cab floors that are level. It can be used in vehicles with cab floors that have a drop ranging between 0.50" and 1.50"

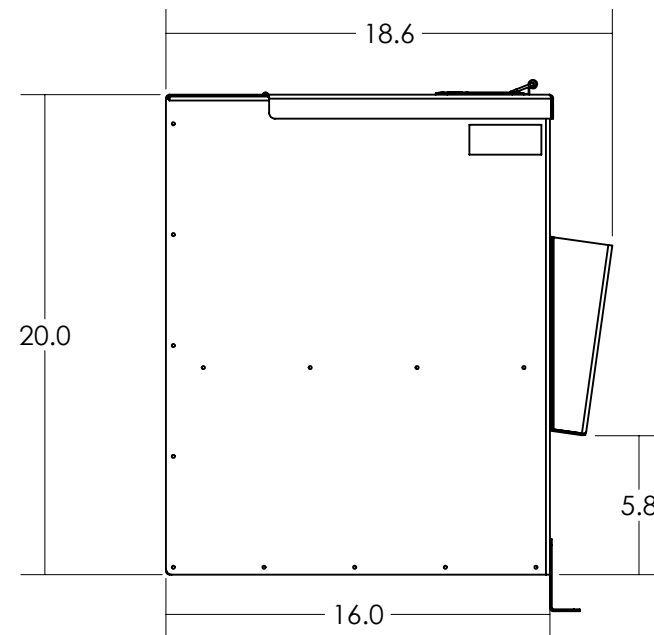
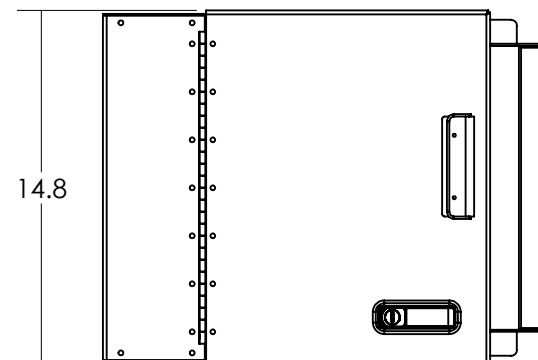

8	040002	1	BOM Sheet
13	N/A	1	Green 12" File Folder
7	N/A	1	Keys (taped to inside of cab organizer)
6	642015	4	#10 x 1" Hex Plated Self Drill Screw
5	642054	4	1/4-20 Nyloc Flanged Nut - Zinc
4	642062	7	1/4"-20 x 5/8" Pan Head Bolt -
3	049010	1	Cab Organizer- Inner Tray
2	049002	1	Cargo-Cube Cab Organizer Box 16"D
1	041020	1	Cargo-Cube Cab Organizer - Front Mounting Bracket
#	PART NO.	QTY.	DESCRIPTION

Rev. Weight
-- 17.92 Lbs.

JM
7541 Chapman Ave Unit B
Garden Grove, Ca 92841

Description Cargo-Cube Cab Organizer Box 16"D			
Material .080 Alum. 5052	Item No. 040002	Size	Date
PROPRIETARY AND CONFIDENTIAL THE INFORMATION CONTAINED IN THIS DRAWING IS THE SOLE PROPERTY OF J&M TRUCK BODIES. ANY REPRODUCTION IN PART OR AS A WHOLE WITHOUT THE WRITTEN PERMISSION OF J&M TRUCK BODIES IS PROHIBITED.		A	6/24/2018
Drawn By. J. Chauvin		SCALE: 1:8	

5

4

3

2

1